



Targeted Brownfields Assessment (TBA) Application

EPA Region 8 accepts applications for environmental assessment assistance at brownfields properties on an ongoing basis. To request Region 8's technical assistance, please complete this application. The information provided will be evaluated to determine if the applicant and site meet the selection criteria for the TBA program. EPA will also evaluate whether funding is available to perform the requested assessment within the desired schedule. Applicants will be contacted promptly after this review. For more information on TBAs, please visit: www.epa.gov/region8/brownfields/tba.html

1. Applicant Information

Applicant Organization	Flandreau Santee Sioux Tribe
Contact Person and Title	Elizabeth Wakeman, Brownfields / Tribal Response Program Coordinator
Street Address	P.O. Box 283
City, State ZIP Code	Flandreau, SD 57028
Phone	605-997-5123
Fax	605-997-5230
Email Address	fsstbfc@mchsi.com

2. Site Description and History

Site Name	Helen Hart Residence
Address	SW ¼ of Section 10 7107 N R48W
Acreage	160 square feet
Lat/Long Coordinates	N 44° 5.044 W 096° 34.893
Current Owner's Name	Flandreau Santee Sioux Tribe
Current Owner's Address	P.O Box 283, Flandreau, SD 57028

A. Please provide a brief description of the property and the specific assessment(s) you wish to have performed (e.g., Phase I, II and/or cleanup planning):

We would like a Phase I and Phase II to be done by EPA.

B. When you would like the assessment(s) to be conducted? What is the project timeline?

We would like this done immediately.

C. Why would you like the assessment(s) conducted? (TBAs can be used to facilitate property acquisitions, meet EPA grant application requirements, characterize contamination for environmental cleanup, among other reasons.)

The area is an endangerment to cattle, horses, and children who visit the resident.

- D. Describe the environmental conditions at the site, including potential contaminants and a summary of any known past environmental investigations. Describe the past uses of the site.**

The site has old refrigerators, stoves, iron, asbestos, empty barrels of unknown content, pesticides, dumped oil. The site was a home, until it was accidentally burned. It then became abandoned and used by a resident to dump oil.

- E. Is the applicant the property owner? (Yes/No) Yes**

- F. If not, does the applicant have legal permission to enter the property to conduct the site assessment activities? (Yes/No) Note, applicant will be required to secure access.**

- G. Do you know how and when the contamination occurred? (Yes/No) If yes, describe. Note, applicants who are responsible for causing contamination are not eligible for assistance under this program.**

We were informed a year ago of the site and recently investigated the site.

- H. Describe any state or federal regulatory involvement at the site related to its environmental condition.**

- I. Is there an ongoing or planned state or federal enforcement action or order at the site? (Yes/No) If yes, please explain. No**

- a. **Is the site on any state or federal environmental lists, such as the National Priorities Lists (NPL) or the Leaking Underground Storage Tanks (LUST) list? (Yes/No) If yes, please explain. No**
- b. **If petroleum contamination is suspected, has the applicant worked with the State or EPA to determine eligibility*? (Yes/No/NA) If yes, please explain. No, we are waiting for EPA, to determine eligibility.**

3. Property Reuse and Redevelopment

- A. Describe the anticipated reuse or redevelopment of the property.**

It will be used for agricultural purposes and farm animal use.

- B. Describe any commitments in place to show this brownfields site will be cleaned up and redeveloped or reused. Please indicate potential or secured funding sources for cleanup and redevelopment.**

Once cleaned up the resident will use the area for farm use. However EPA has to make the decision to clean up the site. The economy is down and agriculture and farm animals need to be taken care of for use of our tribal people.

- C. Describe how site reuse/redevelopment will benefit the community (e.g., creation of jobs, green space, parks, sustainable/green redevelopment, a catalyst for further redevelopment in the area, etc). Privately owned sites must provide a substantial public benefit.**

The site would be used for cattle or crop growth. The area will be used for the health and welfare of our people.

- D. Will the property be sold or transferred to a different entity? If so, please**

describe. No

E. Describe the roles of stakeholders in the project, e.g., community organizations, local government involvement, etc.

Tribal people want their lands to be clean for their own health and welfare.

F. Describe efforts directed towards involving the community in site reuse planning activities.

Resident hinted of possible community garden.

4. Additional Information

Please email any supporting documentation such as regional and site location maps, photographs, prior site assessment reports and historical environmental information, if available, to the email address provided below.

5. Contact Information

To submit your application or for questions, please contact Bill Rothenmeyer, TBA Program Manager:

Email: rothenmeyer.william@epa.gov

Phone: 303-312-6045

Fax: 303-312-6065

*The Brownfields Law outlines specific criteria by which petroleum sites may be eligible for brownfields funding. Briefly, these criteria are that the site must be of "relatively low risk," there can be no viable responsible party, the applicant cannot be potentially liable for cleaning up the site, and the site must not be subject to a Resource Conservation and Recovery Act (RCRA) corrective action order. If a party is identified as being responsible for the site and that party is financially viable, then the site is not eligible for brownfields grant funds. For more information, visit www.epa.gov/oswer/docs/grants/epa-oswer-oblr-11-05.pdf.

**Flandreau Santee Sioux Tribe
Natural Resources
Brownfields Tribal Response Program
Inventory Questionnaire**

Form Number: FSST # 05

Date: 8-8-2013

Time: 8:00AM

Anonymous Information?

Yes:

No:

If no, please answer the following questions:

Name: _____

Address: _____

Phone: _____

Description of Site: Helen Hart Residence

SW 1/4 of section 10 7107 N R 48 W The area consists of 160 square feet. N 44° 5.044 W. 096° 34.893. The property is owned by the Flandreau Santee Sioux Tribe.

Site Location/Directions:

The site is located at the Helen Hart residence, just North of the house she resides in. The residence is located at SW 1/4 of Section 10 7107 N R 48 W.

Other Person(s) that may be knowledgeable of sites past and present uses:

Helen Hart, Flandreau Santee Sioux Tribe Land Management Committee

Potential/Known Environmental Threats/Hazards existing on site:

Dumped oil, old refrigerators (freon), empty barrels (contents unknown), iron, asbestos, pesticides, old stoves, cement, charred remains

Other important information:

Signature of Person completing questionnaire: 

**Flandreau Santee Sioux Tribe Natural Resources
Brownfields Tribal Response Program
Site Inventory Information Sheet**

Date: 8-5-2013 Site Name: Helen Hart Residence

Form completed by: Natasha Eagle Star

Directions to Site: Take Highway 13 2.2 miles to 228th street Go 0.3 miles then take a left for .2 miles

Site Description:

Address: (county/state) 48124 - 48146 228th St. Flandreau, SD 57028

Lat/Long: N 44° 5.044 W. 096° 34.893

Township/Range/Section:

Parcel/Allotment Number(s):

Current Property Owner: Flandreau Santee Sioux Tribe

Current Use of Property: None

Future Use of Property: Agricultural Purposes and farm animal use

Neighborhood: Residential: Industrial: Rural: Other:

Site & Vicinity general characteristics: (terrain, elevation, general land use in area, vegetation, location to nearest town)

Physical Setting:

Geologic Information:
-geological formations/thickness
-bedrock name/depth
-faults/structural features
-(within 4 miles)

Hydraulic Information:
-depth to groundwater
-aquifers under site
-hydraulic conductivity
-confined/unconfined
-recharge area
-interconnections

Hydrology:
-surface water flow direction
-annual mean discharge rate of surface water
-drainage area up-gradient of site
-floodplain information
-wetlands or water bodies

Historical Information:

Property use Past/Present: In the past was a home then used for storage. Was accidentally burnt down and was used as an oil dumping spot.

Previous owner:

Potential environmental threats: Dumped oil, asbestos, drums rusted with contents unknown.

Site Reconnaissance:

Description of each structure:
(Size/condition/construction materials)

Interior Observations:
(Heating/cooling/stains/
corrosion/drains/sumps/
possible asbestos)

asbestos, rust, cement, old refrigerators, stoves, iron, dumped oil, empty barrels, and drums, pesticides

Fence/Gates: (condition/type/locked):

Electric fence around area but was shut off when looking at the site.

Approximate size of Property (acres):

.5 acres

General slope of site:

Water Supply: Potable Non-Potable Groundwater Surface Water None

Wells: monitoring drinking irrigation none other

Sewage Disposal System: Septic connected to public system none other

Roads: paved gravel dirt stained gates

Containers identified:
(Include number/size/conditions)

Drums/small containers:

unidentifiable contents. Several located around area.

Hazardous substances or petroleum products in connection with identified uses:

Oil was dumped inside the open area of the home into the basement

Unidentified substance containers:

Several found and some are rusted with no labels. Cans found around area with no labels

Potential contaminants/indicators identified:

Used oil, possibly freon

Hazardous substances or petroleum products in connection with identified uses:

used oil

Underground tanks (pipe or pipe caps):

NA

Above ground tanks/lines:

NA

Buried waste (line of new asphalt, disturbed/subsided soil):

NA

Fresh/imported cap soil, road base, wood chips:

NA

PCBs (including transformers, fluorescent light fixtures):

NA

Odors:

NA

Pools of liquid:

possible under all the rubble

Pits, ponds, trenches, and lagoons:

NA

Stained soil or pavement:

NA

Stressed vegetation: *NA*

Solid waste/debris: (check if present)

- White goods
- Metal debris
- barrels
- containers (list) *unidentifiable*
- carpet
- glass
- untreated wood
- treated wood
- plumbing materials
- tires
- wire
- sheet rock, construction debris
- plastics
- concrete
- household radiators
- fiberglass
- automobile/parts (list)
- household appliances (list) *refrigerators, stoves*
- medicine bottles/other medical debris

Other

(list):

Waste water:

Adjacent Properties:

Agricultural and livestock use. Condition is good except for area mentioned.

Property Use/Condition:

Property is also used for agricultural and livestock use Garden located around house.

Targets:

Nearest resident, drinking water well:

Human/indicators present:

Animal indicators present:

Surface water bodies/location:

Surface Water drainage from site:

Rain/storm drainage patterns:

Evidence of fishing/location:

Dust blowing off site:

Summary of recognized environmental conditions:



07/02/2013 09:



07/02/2013 09:

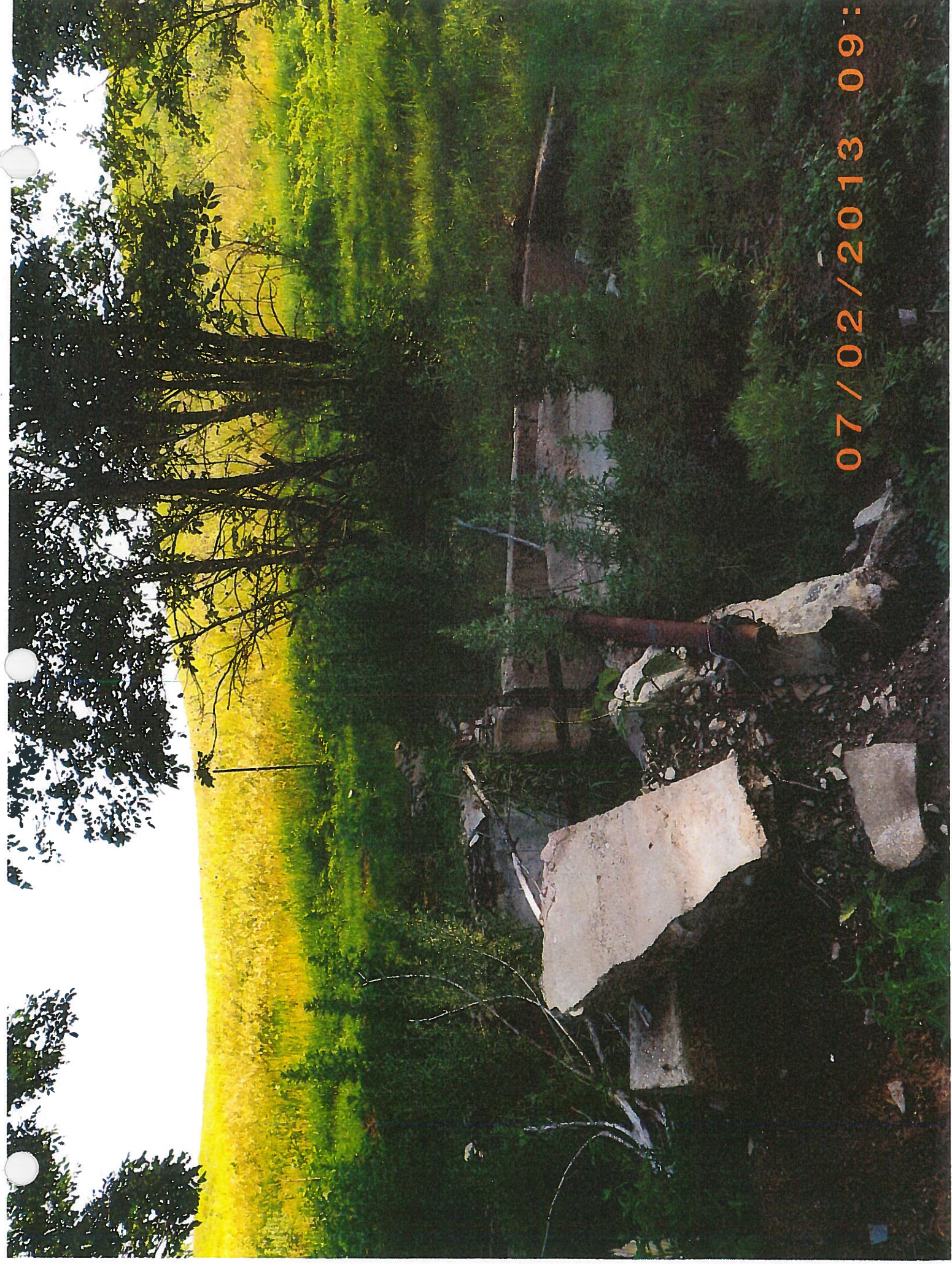

07/02/2013 09: