

Flandreau Santee Sioux Tribe  
Natural Resources  
Brownfields Tribal Response Program  
Inventory Questionnaire

Form Number: 0004

Date: 2-5-09

Time: 11:00 AM

Anonymous Information?

Yes: V

No: \_\_\_\_\_

If no, please answer the following questions:

FSS T, Gravel Pit

Name: \_\_\_\_\_

Address: \_\_\_\_\_

Phone: \_\_\_\_\_

Description of Site:

Abandon storage shed & silo Next to Ammo  
Shooting range used by Royal River Casino Security.

Site Location/Directions:

\_\_\_\_\_  
\_\_\_\_\_  
\_\_\_\_\_

Other Person(s) that may be knowledgeable of sites past and present uses:

\_\_\_\_\_  
\_\_\_\_\_

Potential/known Environmental Threats/Hazards existing on site:

Potential Hazardous waste

Other important information:

Site is used as a storage, however it is  
becoming a work site.

Signature of Person completing questionnaire: \_\_\_\_\_

**Flandreau Santee Sioux Tribe Natural Resources  
Brownfields Tribal Response Program  
Site Inventory Information Sheet**

Date: Feb 5, 2009 Site Name: FSST Gravel pit

Form completed by: Elizabeth Wickman

Directions to Site: — miles from town

Site Description:

Address: (county/state) Moody county

Lat/Long: N 44° 04.063 W 096° 31.744'

Township/Range/Section:

Parcel/Allotment Number(s):

Current Property Owner: FSST

Current Use of Property: Amphib Target range + Sweat lodge

Future Use of Property: unknown

Neighborhood: Residential:  Industrial:  Rural:  Other:

Site & Vicinity general characteristics: (terrain, elevation, general land use in area, vegetation, location to nearest town)

**Physical Setting:**

Geologic Information:  
 -geological formations/thickness  
 -bedrock name/depth  
 -faults/structural features  
 -(within 4 miles)

(GVA)  
 Grovena - Bonilla loams 0 to 2% slopes. The Grovena series consists of deep, well drained soils formed in loamy eolian material on upland. Permeability is moderate. This soil has high available water capacity and moderate organic matter content. Flooding is none.

Hydraulic Information:  
 -depth to groundwater  
 -aquifers under site  
 -hydraulic conductivity  
 -confined/unconfined  
 -recharge area  
 -interconnections

The Bonilla series consists of very deep, moderately well drained series formed in loamy glacial drift in drainage ways and swales of the upland. Permeability is moderate in the solum and moderately slow or moderate in the underlying material. This soil has high available water capacity + high organic matter content. Flooding is none.

Hydrology:  
 -surface water flow direction  
 -annual mean discharge rate of surface water  
 -drainage area up-gradient of site  
 -floodplain information  
 -wetlands or water bodies

Hydrologic Group B.

**Historical Information:**

Property use Past/Present:

Previous owner:

Potential environmental threats:

**Site Reconnaissance:**

Description of each structure:  
(Size/condition/construction materials)

Storage shed, silo

Interior Observations:  
(Heating/cooling/stains/  
corrosion/drains/sumps/  
possible asbestos)

Soil and Block

Fence/Gates: (condition/type/locked):

NONE

Approximate size of Property (acres):

7.5 ACRES

General slope of site:

YES

Water Supply:  Potable  Non-Potable  Groundwater  Surface Water  None

Wells:  monitoring  drinking  irrigation  none  other

ABANDON

Sewage Disposal System:  Septic  connected to public system  none  other

Roads:  paved  gravel  dirt  stained  gates

Containers identified:  
(Include number/size/conditions)

Pesticide Trailor

Drums/small containers:

2

Hazardous substances or petroleum products in connection with identified uses:

yes

Unidentified substance containers:

yes

Potential contaminants/indicators identified:

Pesticide, oil

Hazardous substances or petroleum products in connection with identified uses:

unsure

Underground tanks (pipe or pipe caps):

unsure

Above ground tanks/lines:

unsure

Buried waste (line of new asphalt, disturbed/subsided soil):

unsure

Fresh/imported cap soil, road base, wood chips:

none

PCBs (including transformers, fluorescent light fixtures):

yes

Odors:

yes

Pools of liquid:

unsure snow cover

Pits, ponds, trenches, and lagoons:

unsure snow cover

Stained soil or pavement:

yes

Stressed vegetation:

no

Solid waste/debris: (check if present)

- White goods
- Metal debris
- barrels
- containers (list)
- carpet
- glass
- untreated wood
- treated wood
- plumbing materials
- tires
- wire
- sheet rock, construction debris
- plastics
- concrete
- household
- radiators
- fiberglass
- automobile/parts (list)
- household appliances (list) STOVE, COMPUTERS
- medicine bottles/other medical debris

Other (list): Ewaste computers, pesticide sprayer, Air Conditioner

Waste water:

NO

Adjacent Properties:

poor condition

Property Use/Condition:

Targets:

Nearest resident, drinking water well:

None except for ammo range

Human/indicators present:

Rodents + Pidgeons

Animal indicators present:

Surface water bodies/location:

NO

Surface Water drainage from site:

NO

Rain/storm drainage patterns:

Away from buildings

Evidence of fishing/location:

NO

Dust blowing off site:

yes

Summary of recognized environmental conditions:



Site no# 0004 2-5-09

#1520



#151

Site no# 0004 2-5-09



Site no # 0004 3-5-09

#1536



18-107-48

Customer(s): FSST

Field Office:

Agency:

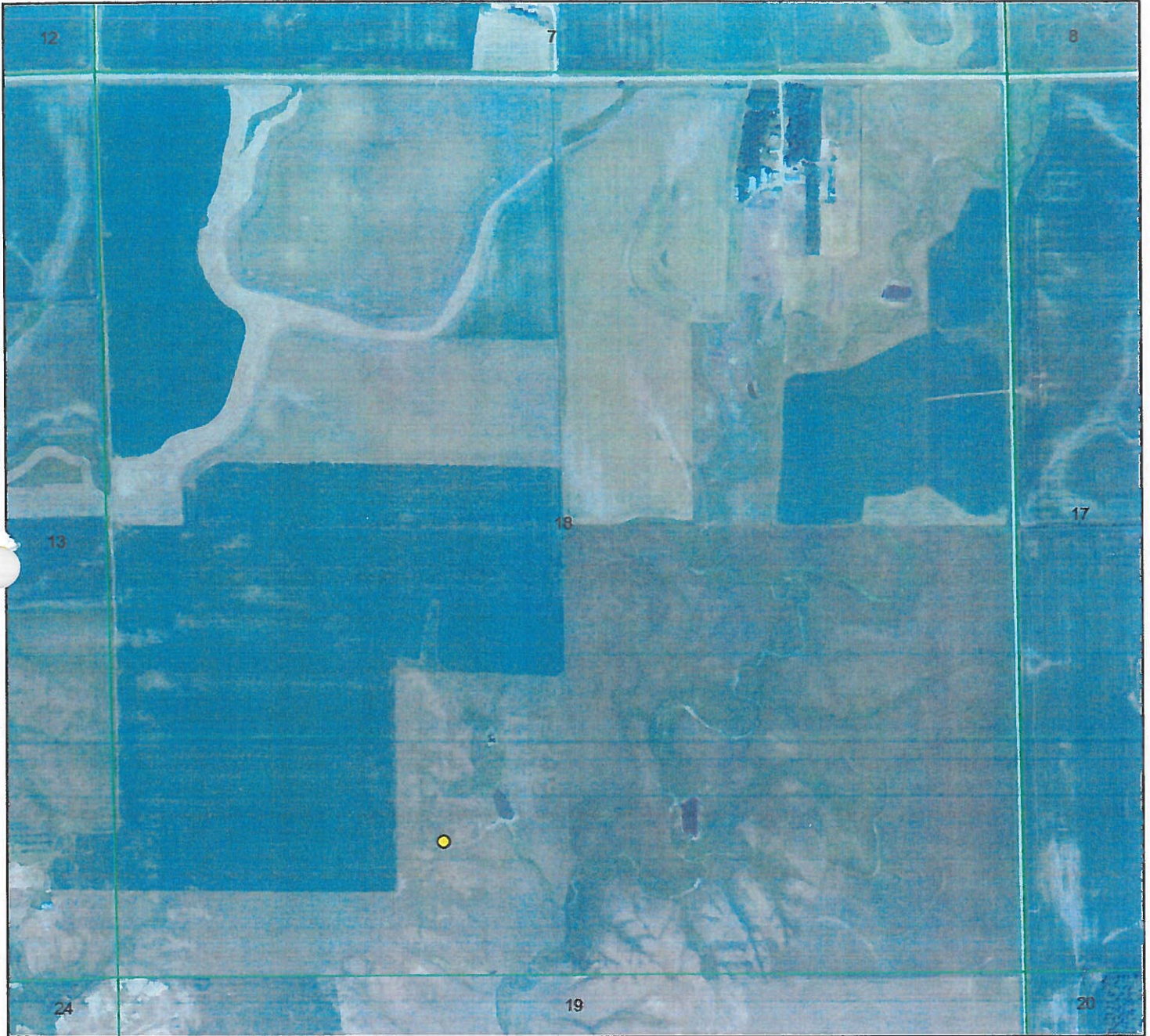

**Legend**

● Resource Inventory (Point)

□ Sections













