

Flandreau Santee Sioux Tribe
Natural Resources
Brownfields Tribal Response Program
Inventory Questionnaire

Miyasato
Form Number: 0001

Date: 2-4-09

Time: _____

Anonymous Information?

Yes:

No: _____

If no, please answer the following questions:

Name: _____

Address: _____

Phone: _____

Description of Site:

Abandon Sheds (3+), abandon trailer
Abandon unknown Chemical, metal parts, car
batteries bicycle parts lawn equipment.

Site Location/Directions:

Other Person(s) that may be knowledgeable of sites past and present uses:

IHS - GAP - TPP - Maintenance Dept - Tribe

Potential/Known Environmental Threats/Hazards existing on site:

Computers

Other important information:

Assessment Be done

Signature of Person completing questionnaire: _____

**Flandreau Santee Sioux Tribe Natural Resources
Brownfields Tribal Response Program
Site Inventory Information Sheet**

Date: <u>Feb. 4, 2009</u>	Site Name: <u>Miyasato</u>
Form completed by: <u>Elizabeth Wakeman</u>	
Directions to Site: <u>X</u>	
Site Description:	
Address: (county/state) <u>Moody County, South Dakota</u>	
Lat/Long: <u>N 44° 03.463 W 096° 33.093</u>	
Township/Range/Section:	
Parcel/Allotment Number(s): <u>X</u>	
Current Property Owner: <u>FSST</u>	
Current Use of Property: <u>Nothing</u>	
Future Use of Property: <u>Turn to Farm land</u>	
Neighborhood: Residential: <input checked="" type="checkbox"/> Industrial: _____ Rural: _____ Other: _____	
Site & Vicinity general characteristics: (terrain, elevation, general land use in area, vegetation, location to nearest town)	
Physical Setting:	
Geologic Information: -geological formations/thickness -bedrock name/depth -faults/structural features -(within 4 miles)	<u>(DaA) Davis loam 0 to 2 percent slopes. The Davis series consists of deep, well drained and moderately well drained soils formed in loamy sediments on foot slopes, fans + high bottom lands. Permeability is moderate. This soil has high available water capacity and high organic matter content. Floodings rare.</u>
Hydraulic Information: -depth to groundwater -aquifers under site -hydraulic conductivity -confined/unconfined -recharge area -interconnections	<u>bottom lands. Permeability is moderate. This soil has high available water capacity and high organic matter content. Floodings rare.</u>
Hydrology: -surface water flow direction -annual mean discharge rate of surface water -drainage area up-gradient of site -floodplain information -wetlands or water bodies	<u>DaA (Hydrologic group B) March, April, May, June Water Table 3.0-5.0 upper limit, > 6.0 lower limit.</u>
Historical Information:	
Property use Past/Present:	
Previous owner:	
Potential environmental threats: <u>Groundwater + Soil contamination</u>	

Site Reconnaissance:

Description of each structure:
(Size/condition/construction materials)

Mobile home - discarded dump

Interior Observations:
(Heating/cooling/stains/
corrosion/drains/sumps/
possible asbestos)

NA

Fence/Gates: (condition/type/locked):

NONE

Approximate size of Property (acres):

1 ACRE

General slope of site:

NONE

Water Supply: Potable Non-Potable Groundwater Surface Water None

Wells: monitoring drinking irrigation none other

Sewage Disposal System: Septic connected to public system none other

Roads: paved gravel dirt stained gates

Containers identified:
(Include number/size/conditions)

none

Drums/small containers:

none

Hazardous substances or petroleum products in connection with identified uses: Computers are broken, busted

Unidentified substance containers:

NA

Potential contaminants/indicators identified:

NA

Hazardous substances or petroleum products in connection with identified uses: NA

Underground tanks (pipe or pipe caps):

septic tank

Above ground tanks/lines:

NONE

Buried waste (line of new asphalt, disturbed/subsided soil):

unsure - snowland

Fresh/imported cap soil, road base, wood chips:

NA

PCBs (including transformers, fluorescent light fixtures):

Fluorescent light fixture

Odors:

Stench strong

Pools of liquid:

unsure (wintertime)

Pits, ponds, trenches, and lagoons:

ponds, Big Sioux River

Stained soil or pavement:

unsure

Stressed vegetation:

to much snow

Solid waste/debris: (check if present)

White goods

Metal debris

barrels

containers (list) _____

carpet

glass

untreated wood

treated wood

plumbing materials

tires

wire

sheet rock, construction debris

plastics

concrete

household

radiators

fiberglass

automobile/parts (list) _____

household appliances (list) _____

medicine bottles/other medical debris

Other

(list): _____

Waste water:

Adjacent Properties:

Property Use/Condition:

Targets:

> 50'

Nearest resident, drinking water well:

Human/indicators present:

Animal indicators present:

Surface water bodies/location:

Surface Water drainage from site:

Rain/storm drainage patterns:

Evidence of fishing/location:

Big Sioux River behind of site

Dust blowing off site:

Summary of recognized environmental conditions:



1484

Site no# 0001 2-4-09



1485

Site no# 0001 2-4-09



Site no# 0001 2-4-09

1480

Customer(s): FSST

Field Office:
Agency:

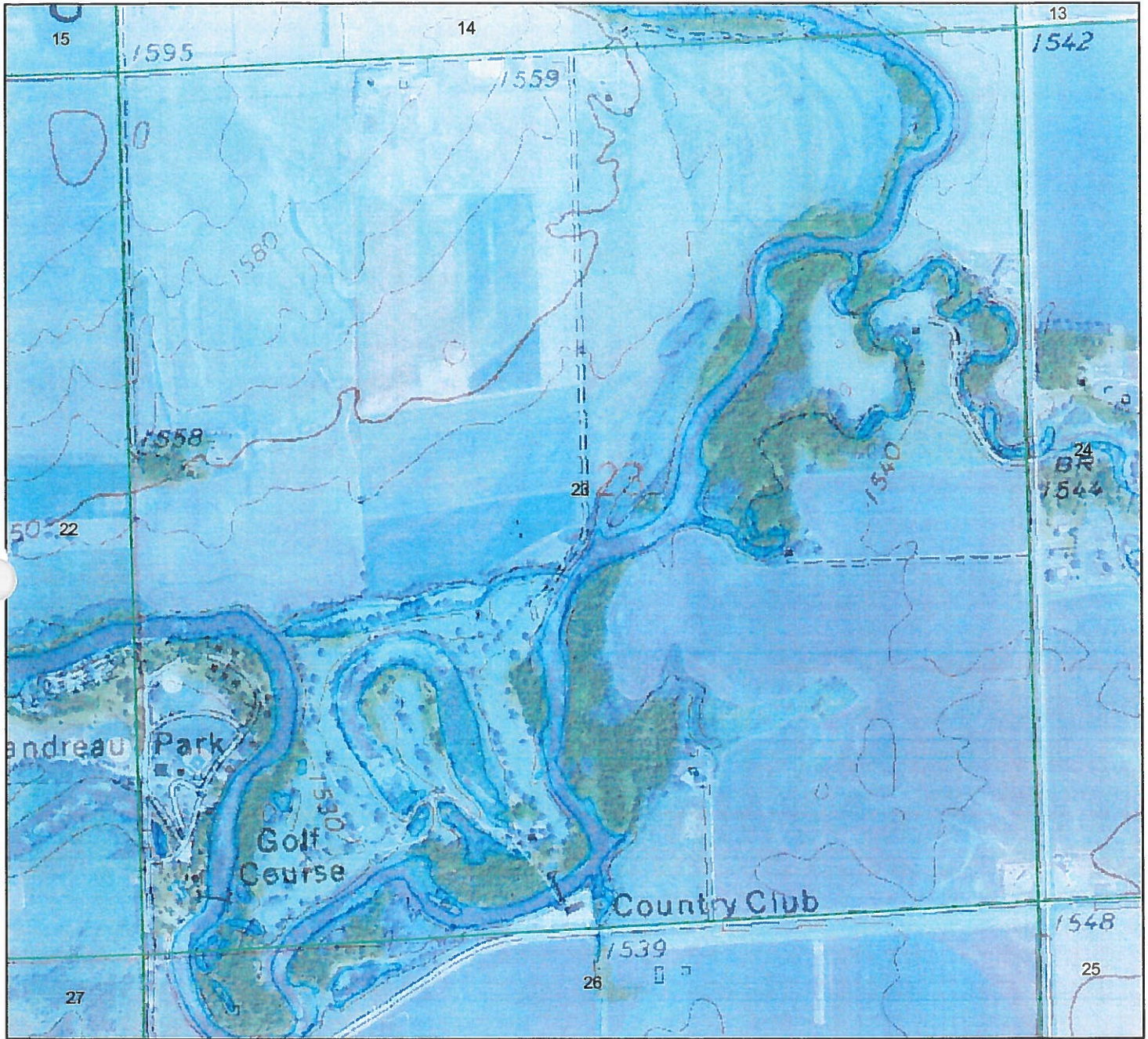

Legend



Sections















